

SM-01322 STARTER DRIVE GEAR / PINION REBUILD KIT

THE OEM MANUFACTURER DOES NOT SELL THE GEARS INDIVIDUALLY. YOU HAVE TO BUY THE ENTIRE CAST ALUMINUM PINION BRACKET ASSEMBLY AT AN INCREDIBLY HIGH PRICE. BECAUSE WE INCLUDE 2 SIZE SPACERS OUR KIT CAN BE USED TO REBUILD THE STARTER PINION ON OEM# 3089759, 1204130, AND 1204372 REFERENCED BELOW.

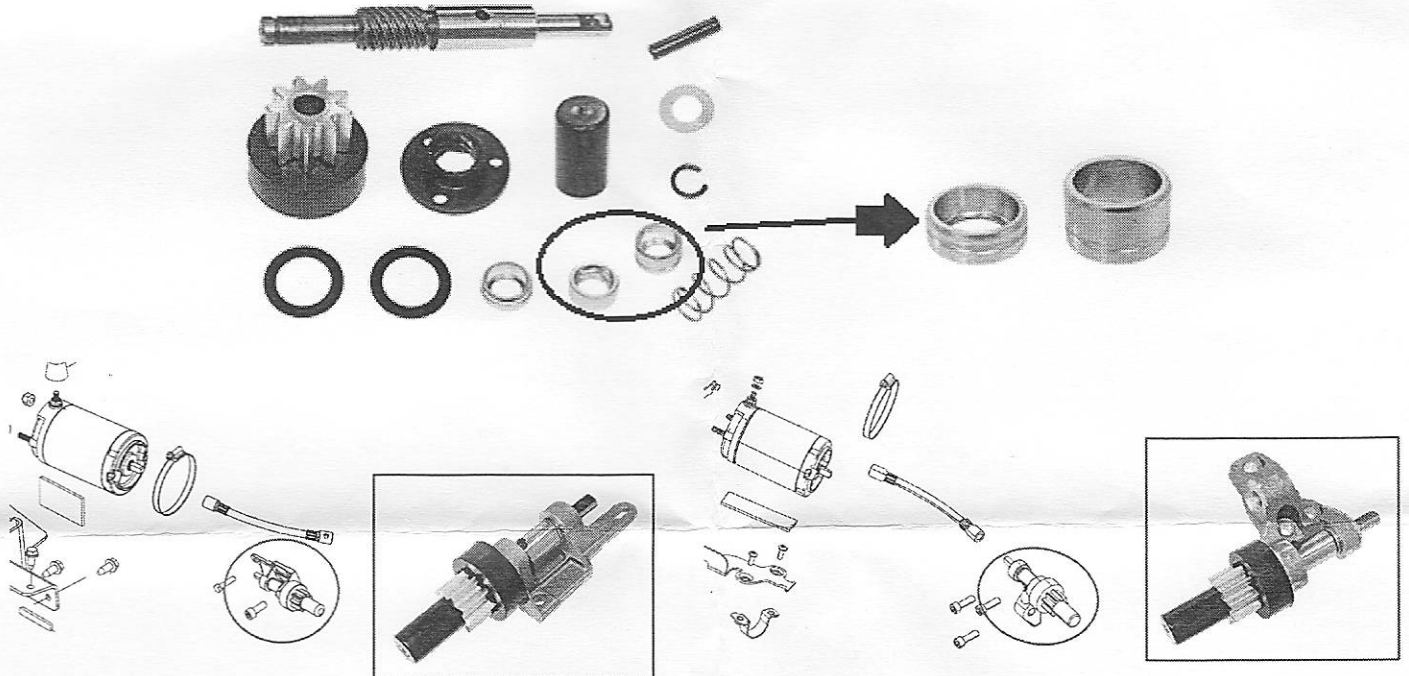

IMPORTANT

*INSTRUCTIONS FOR PINION REMOVAL CAN BE FOUND IN THE MACHINES SERVICE MANUAL.

*LARGE SPACER IS FOR USE REPAIRING P/N'S 1204130 & 3089759

*SMALL SPAVER IS FOR USE REPAIRING P/N'S 1204372

WARNING

*WE HIGHLY RECOMMEND THAT THAT ANY REPAIRS BE DONE BY A CERTIFIED TECHNICIAN.

DISCLAIMER: This item is sold without any expressed or implied warranty of merchantability or fitness for a particular purpose. The Manufacturer, Distributor, nor Dealer shall be held liable for any special, incidental, or consequential damages, including damage, loss of revenue, cost purchased or use of this product.